

SOLIDWORKS Tips and Tricks 2018

The Last Waltz

Phil Sluder
Mechanical Engineer
TriAxial Design and Analysis, Inc.

sluder@triaxialdesign.com
(619) 787-8725

THINK SOLIDWORKS

CREATE

EXPERIENCE

SPEED

GAME CHANGING

SMART DESIGN

NEXT-GEN

COMMUNITY-DRIVEN

EVOLVE



And then I got a tap on my shoulder...

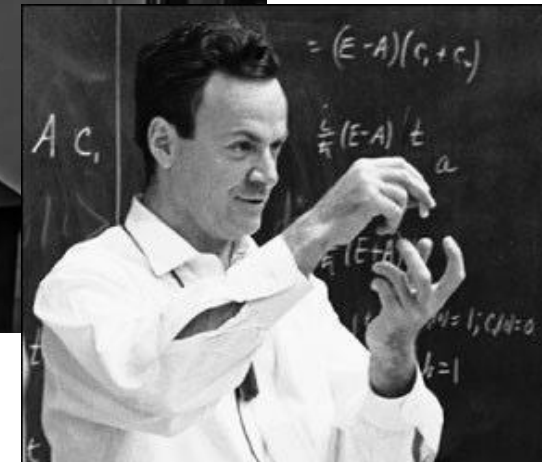
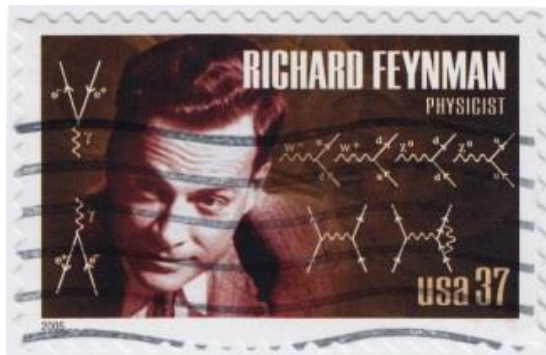
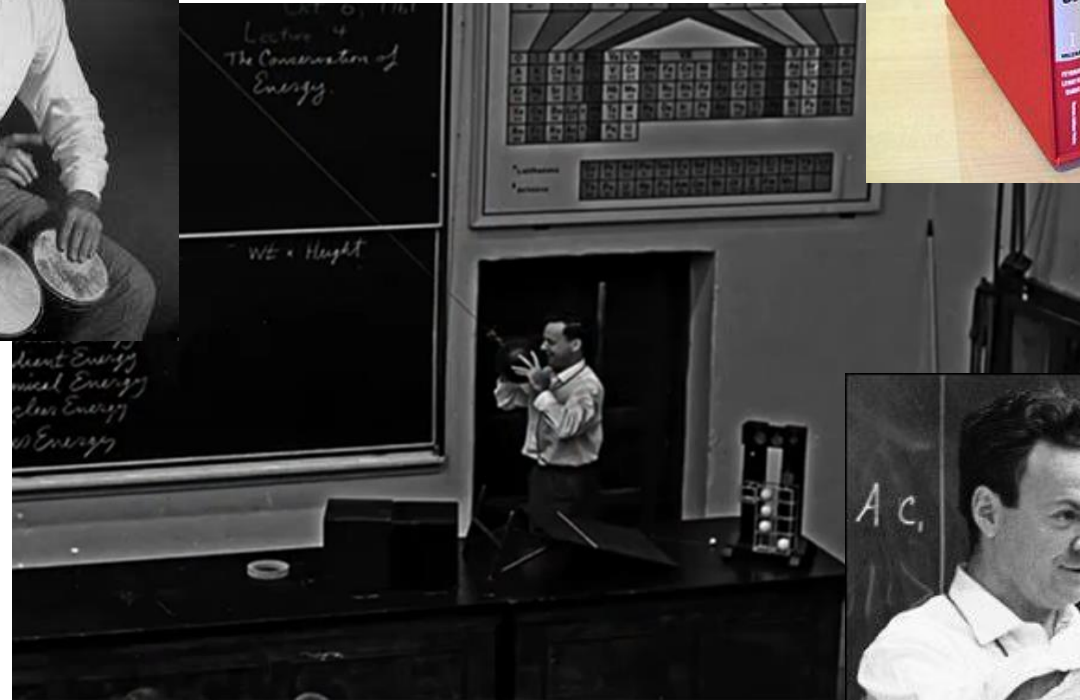

SOLIDWORKS Tips and Tricks 2018

The Last Waltz

Phil Sluder
Mechanical Engineer
TriAxial Design and Analysis, Inc.

sluder@triaxialdesign.com
(619) 787-8725

THINK SOLIDWORKS

CREATE

EXPERIENCE

SPEED

GAME CHANGING

SMART DESIGN

NEXT-GEN

COMMUNITY-DRIVEN

EVOLVE

EXPERT
Mechanical
Design

 SOLIDWORKS

Phil's Definition of a Tip or a Trick?

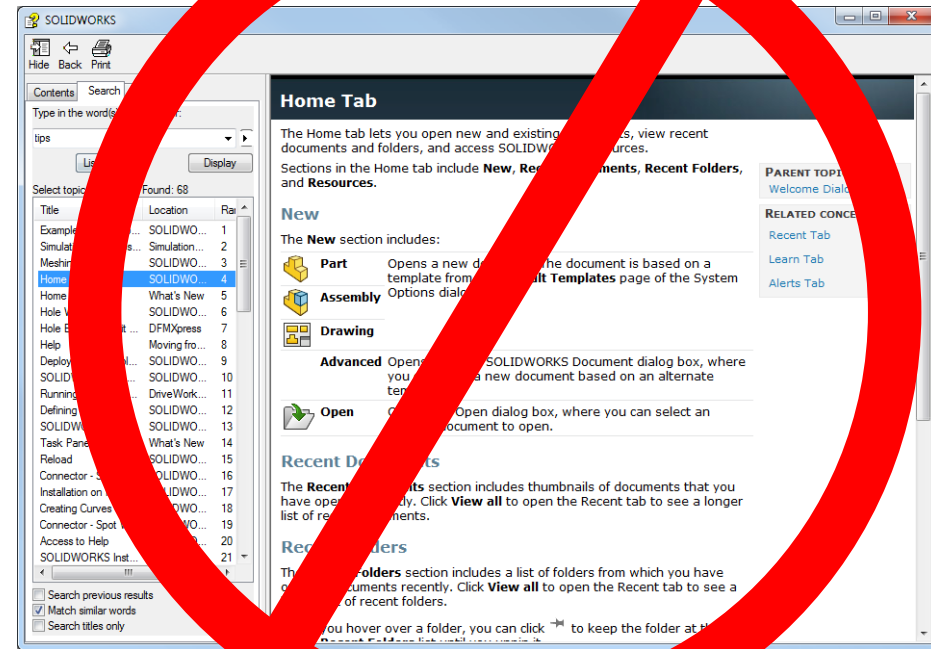

... We walked through the snow, up hill both ways, with shoes so thin you could step on a dime and tell if it was heads or tails...

3DS.COM/SOLIDWORKS © Dassault Systèmes | Confidential Information | 2/8/2018 | ref.: 3DS_Document_2014

Where will you be February 3, 1999?
Have you registered yet?

welcome to **SolidWorks World**
Shaping the Future Palm Springs

Wednesday, February 3rd
9 AM – 5 PM
Certified SolidWorks Professional Testing
Wyndham Hotel – Chino & Pueblo Room
7 PM – 10 PM
Welcome Reception
Pool Side at the Wyndham
User Registration
Palm Springs Convention Center

Thursday, February 4th
7:30 AM – 8:30 AM
Breakfast, User Registration, and Partner Exhibits
Palm Springs Convention Center
8:30 AM – 9:30 AM
Keynotes: Jon Hirschlick
Chief Executive Officer of SolidWorks
Caleb Chung, Co-creator of Furby
Preston Hagman, Express CAD Engineering
Oasis 1&2
9:30 AM – 11 AM
Partner Exhibits
Palm Springs Convention Center

11 AM – 12:30 PM
Session A
Advanced Modeling (PRT3)
Techniques and Principles of Robust Solid Modeling
Room: Ventura

Analysis (A4)
Structural Analysis Through the Ages
Room: Palm C

Education (ED 1)
Using SolidWorks to Teach Engineering Students the Basics
Room: Palm A

Product Session (PS12)
Compaq Computer Corporation
Room: Palm B

Product Session (PS17)
Moldflow Corporation
Room: Palm D

SolidWorks Advanced Assembly Design (ASMS)
Room: Sierra

Technical One-on-One (TECH1)
Room: Pueblo – FULL

SolidWorks Tips and Tricks (TT1)
Room: Mojave Learning Center

12:30 PM – 2 PM
Lunch and Partner Exhibits
Palm Springs Convention Center

2 PM – 3:30 PM
Session B
Analysis (A1)
Integrated Tools for Design Optimization
Room: Ventura

Customer Case Study (CCS2)
Riding the 3D Wave in SolidWorks
Room: Palm B

Education (ED3)
SolidWorks in Education-Integrating SolidWorks Into The Curriculum
Room: Palm C

Technical One-on-One (TECH 2)
Room: Pueblo - FULL

Product Data Management (PDM1)
PDM 101
Room: Sierra

Product Session (PS1)
Overview of Render/View Software
Room: Palm D

Product Session (PS2)
Overview of Mechanical Dynamics
Room: Palm A

Advanced Assembly Design (PRT1)
Consumer Product Design with CAD
Room: Mojave Learning Center

3:30 PM – 6 PM
Exhibits
Palm Springs Convention Center

3:30 PM – 5 PM
Session C
Advanced Modeling (PRT5)
Advanced Methods for Adding a Standard Feature to a Part
Room: Sierra

Analysis (A3)
Advances in Plastic Simulation in a SolidWorks Environment
Room: Palm C

Customer Case Study (CCS4)
Design to Analysis to Manufacturing
Room: Palm B

Increasing Productivity Through Design Automation (IPS)

SolidWorks conference agenda

SolidWorks Conference and Exposition

SolidWorks World
Shaping the Future Palm Springs

SolidWorks Complimentary Admission

SolidWorks Conference and Exposition
February 3-6, 1999

We cordially invite you to join us at the SolidWorks World Conference. Please use the number on this pass when completing your registration materials. This complimentary pass provides you with one FREE admission to all conference activities. PLEASE NOTE: Speakers and Guests: To redeem your complimentary admission we must receive your registration materials no later than 12/20/98.

SolidWorks World
Shaping the Future Palm Springs

8WU3937

SolidWorks Tips and Tricks (TT1)
Room: Mojave Learning Center

Twenty and Out; SolidWorks Tips and Tricks



~~Flexing~~ ~~Deform~~ Cut Extrude, Move Body, Boundary

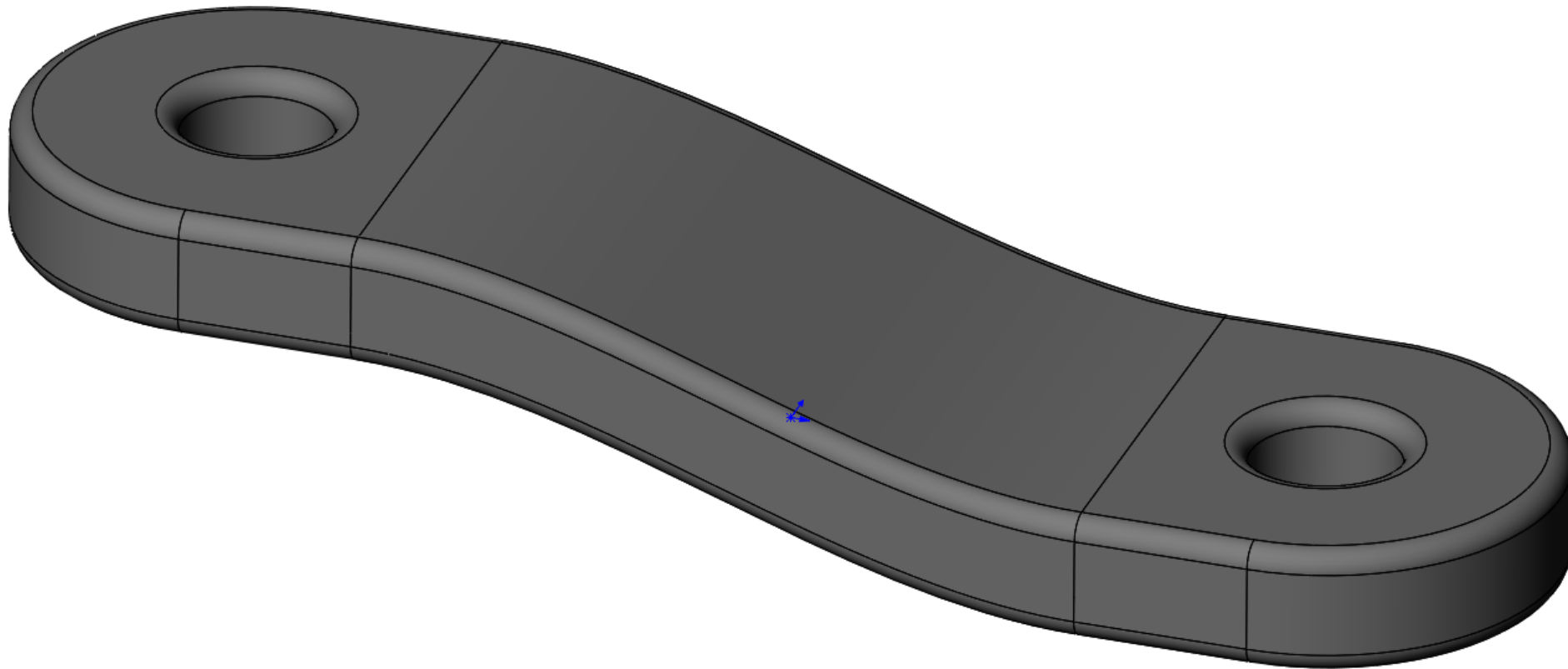

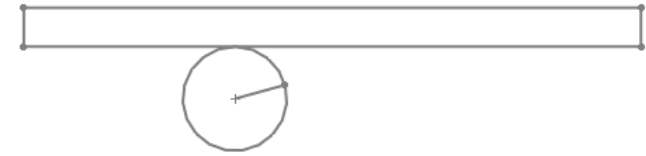
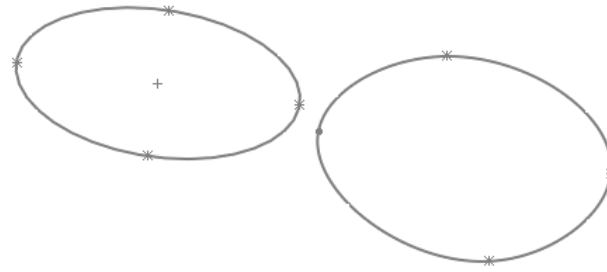

Sketch Blocks / Traction





Selected Entities ▼

Existing Relations ▲

 Traction52

 Fully Defined

Add Relations ▲

-  Tangent
-  Fix
-  Traction

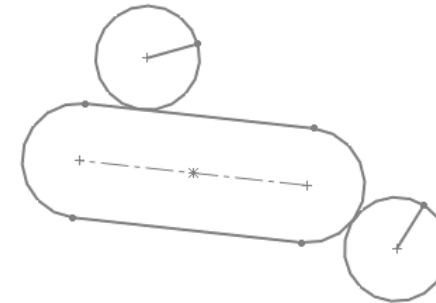
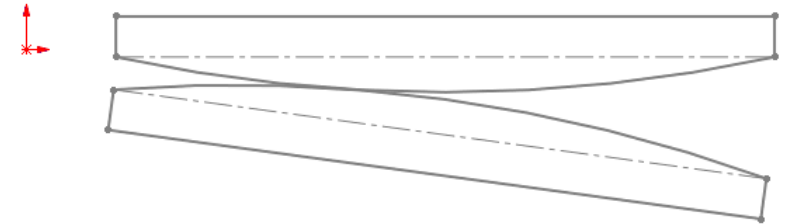
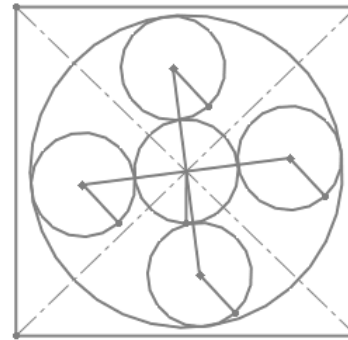

Underwater Basket Weaving



Surfaces – Three Highlights 1/3

Refine



Add



Construct

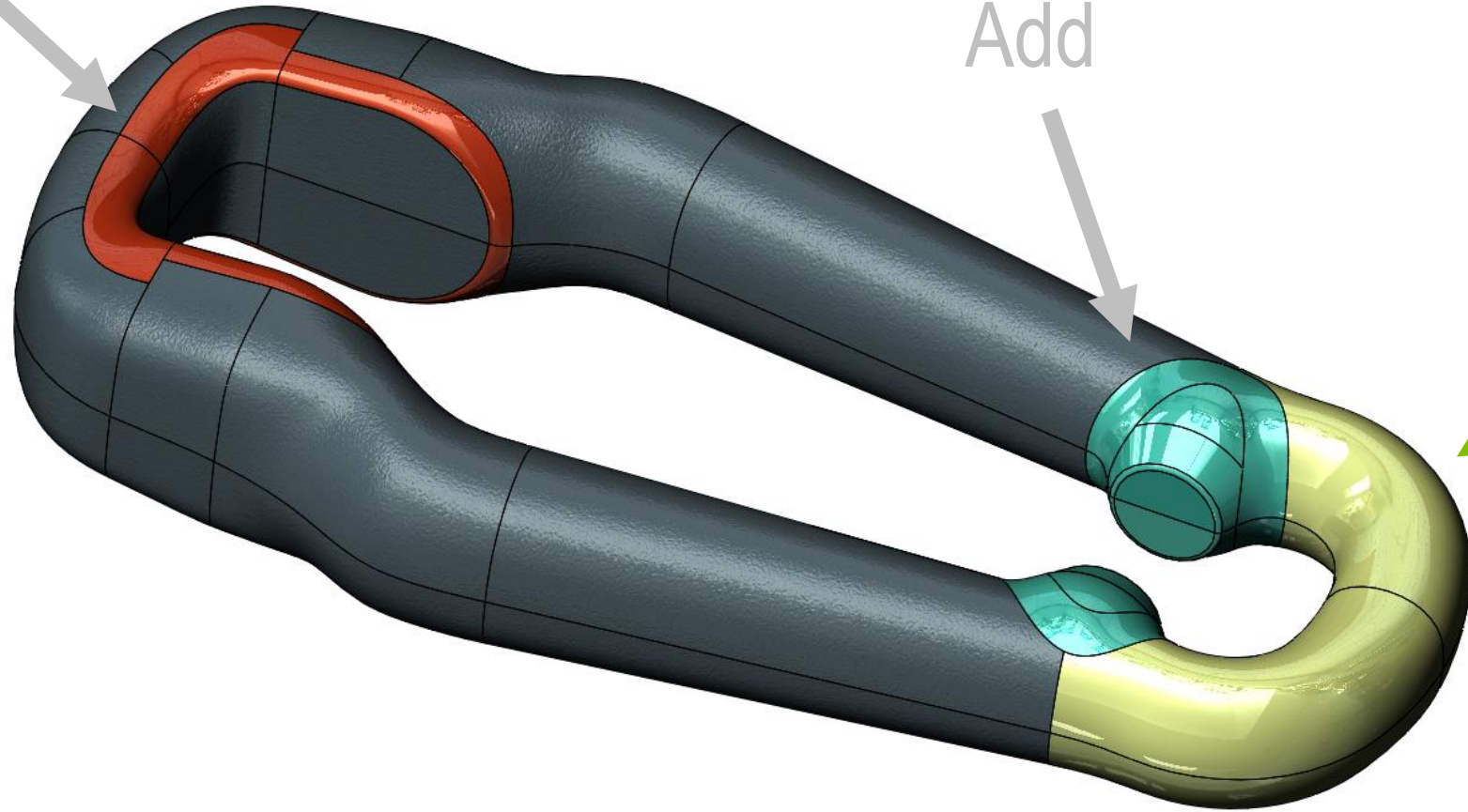

Various Draft Options

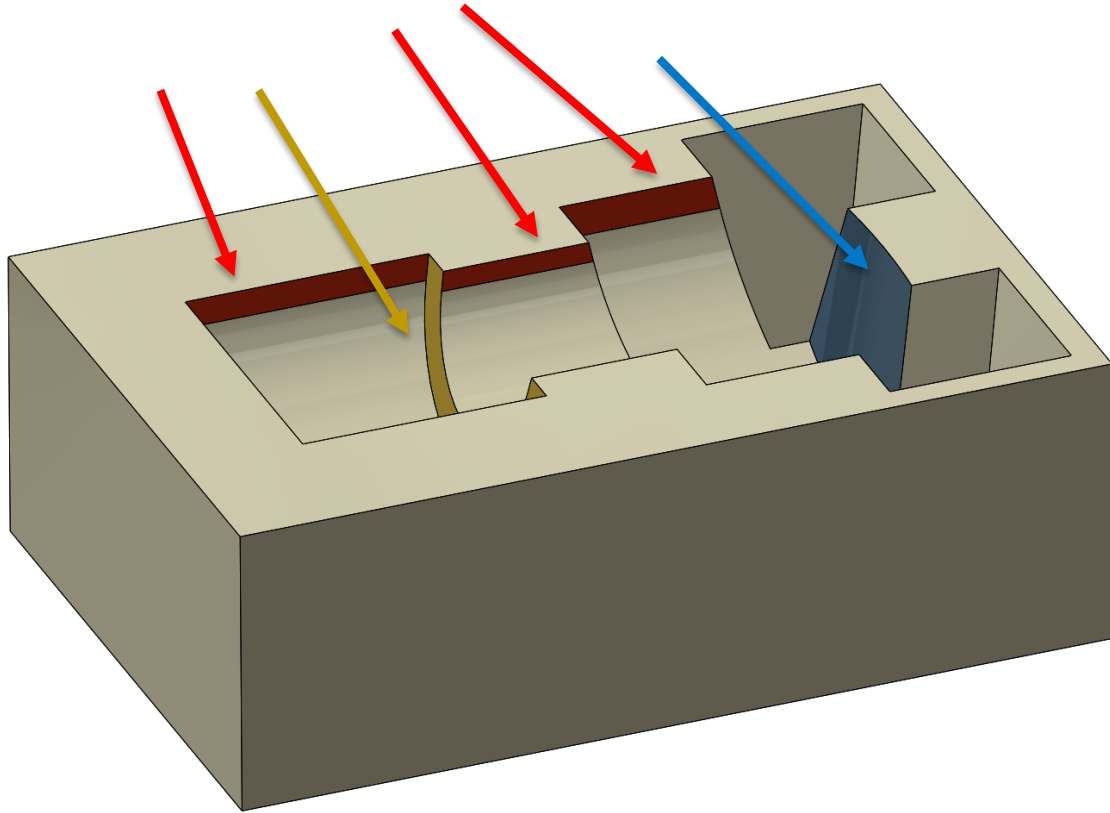

Extrude with Draft

~~Revolve with Draft~~

Draft, Neutral Plane

Draft, Parting Line

Move Face, Revolve

Curve, Split Line, Silhouette
and Draft, Parting Line

Surfaces – Three Highlights 2/3

Refine

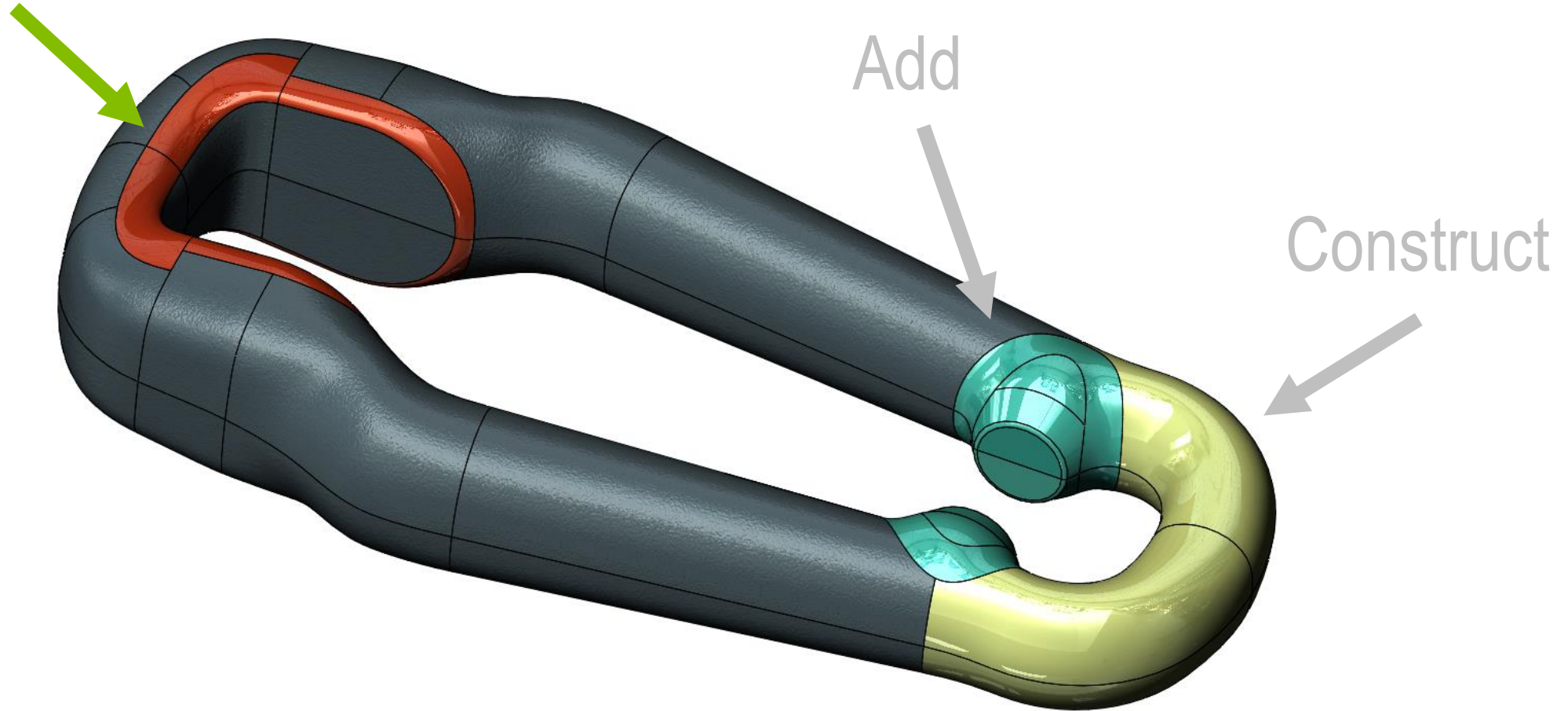

Combine / Intersect

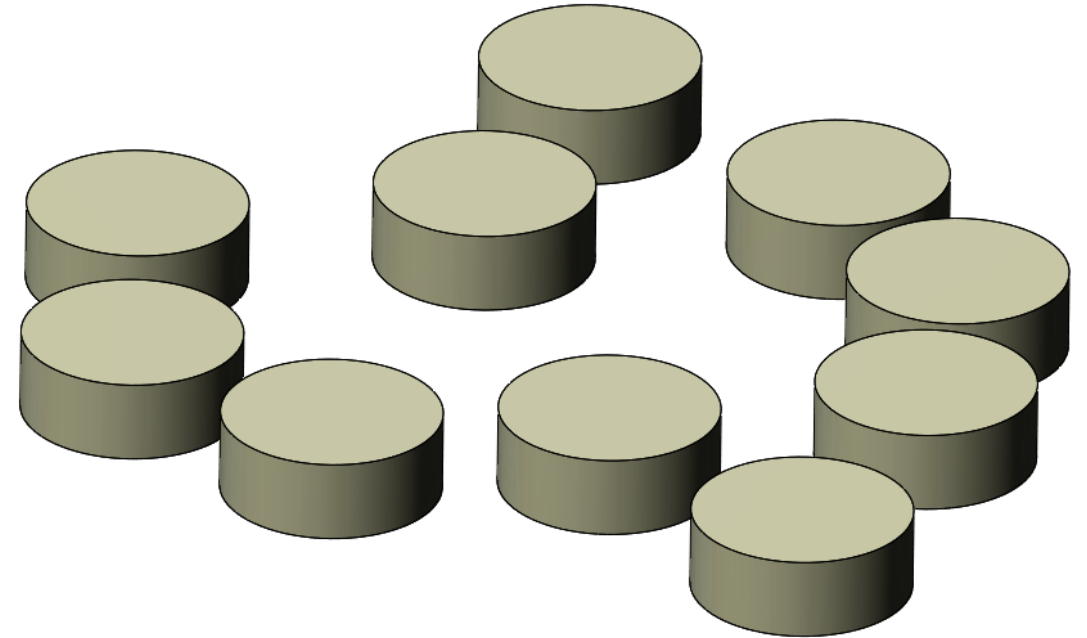
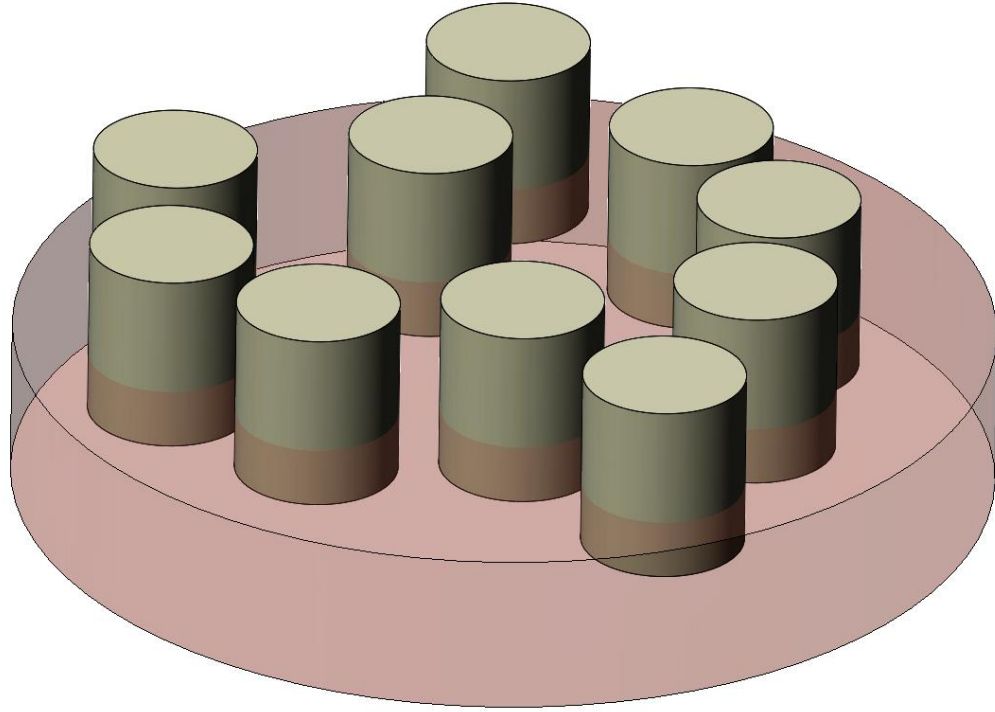

Wrap Functionality – Analytical Surface Method 1/2

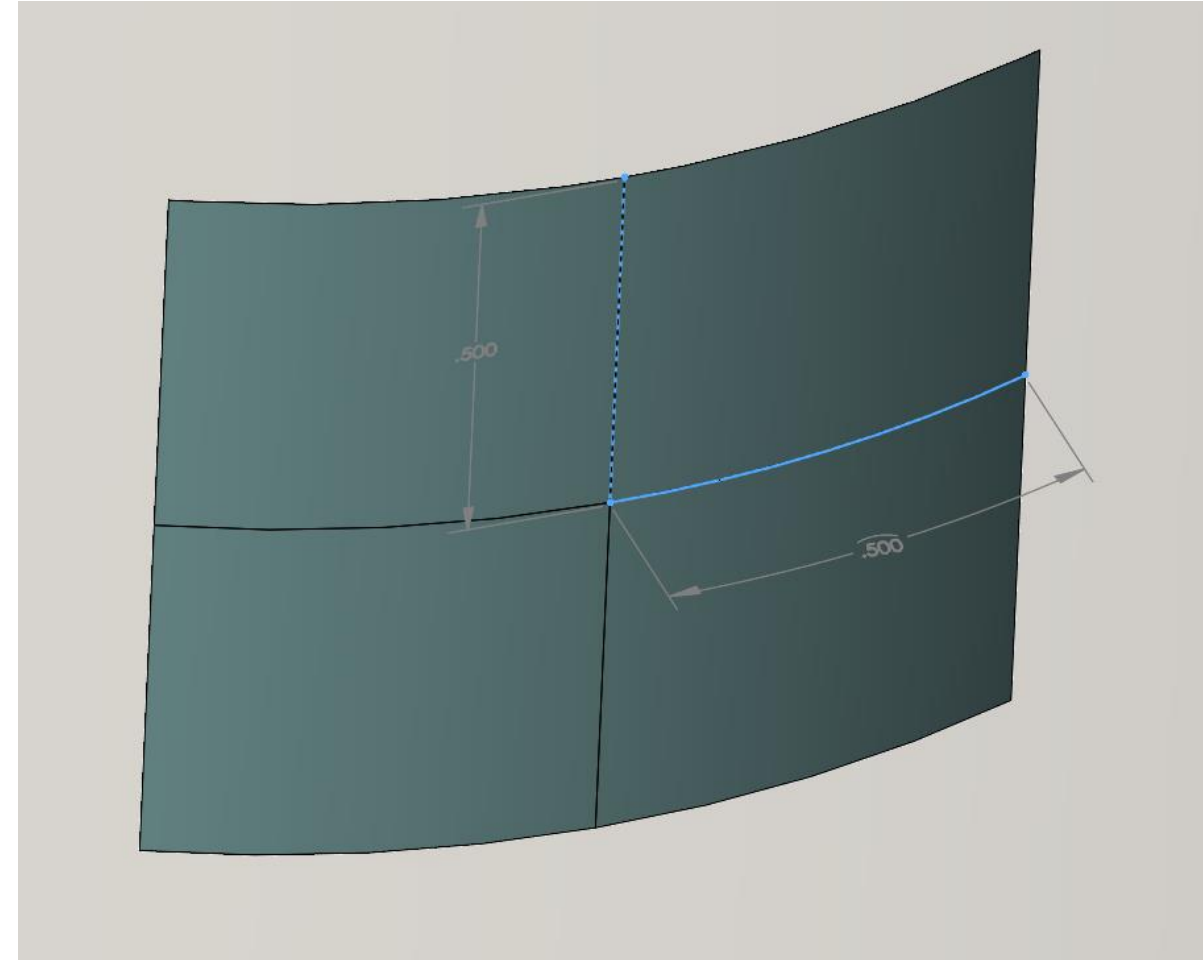
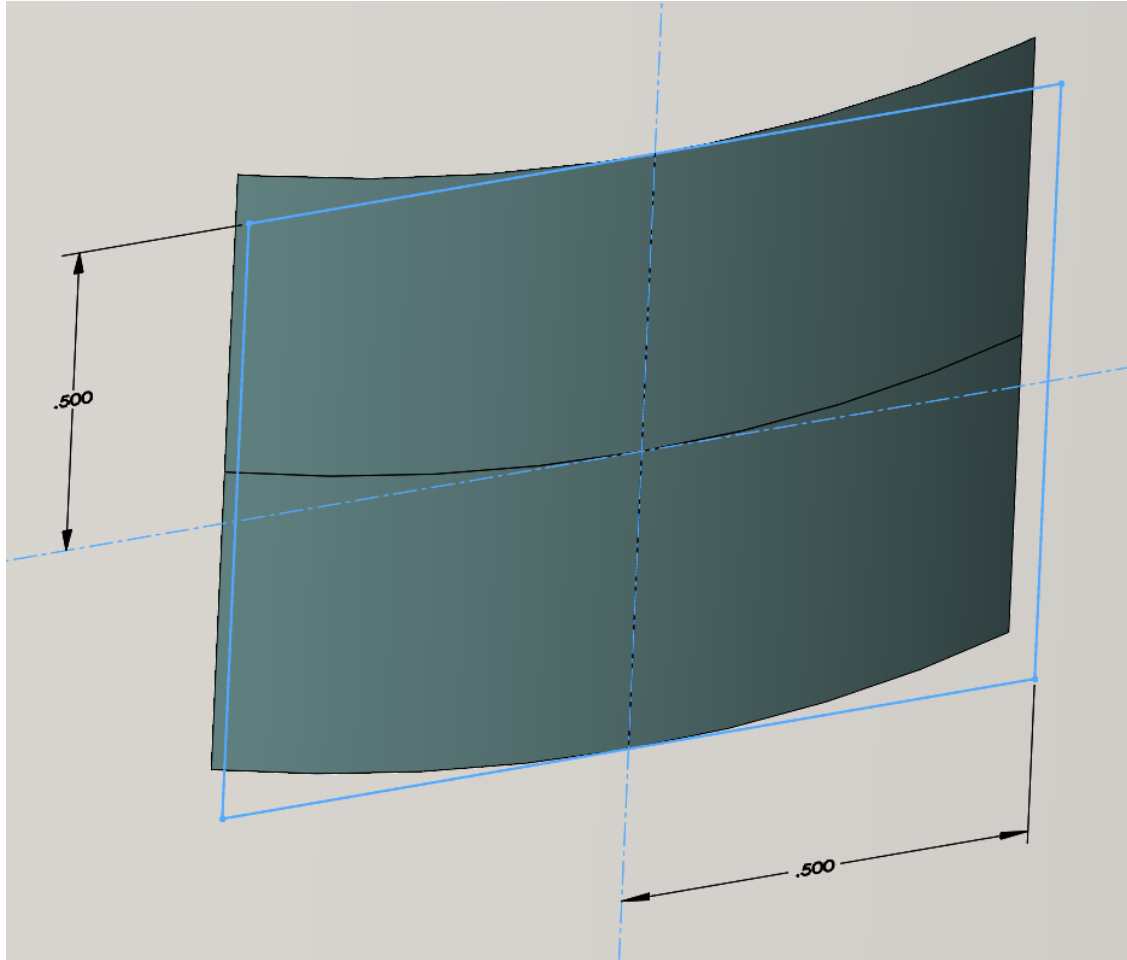

Centered

Wrap Functionality – Analytical Surface Method 2/2

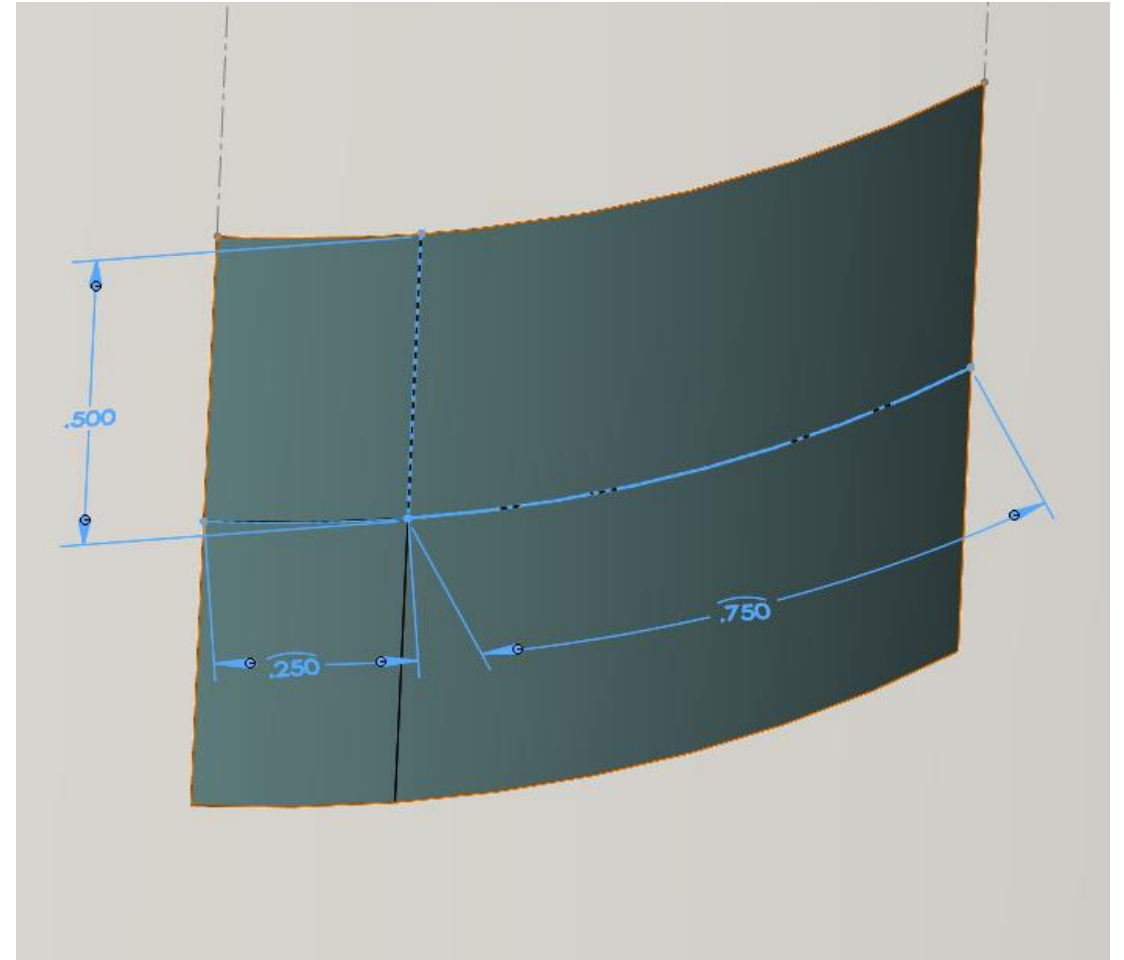
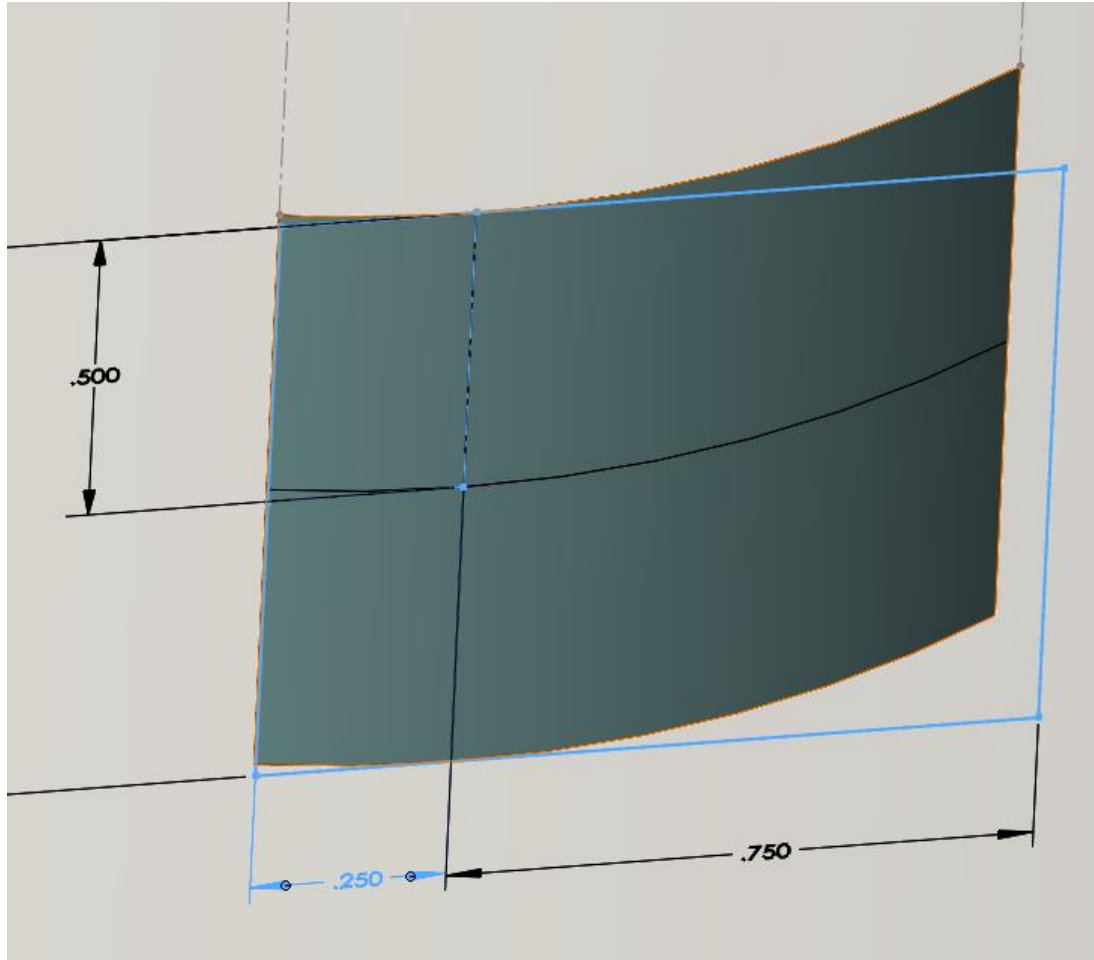

Offset Right

Wrap Functionality – Spline Surface Method

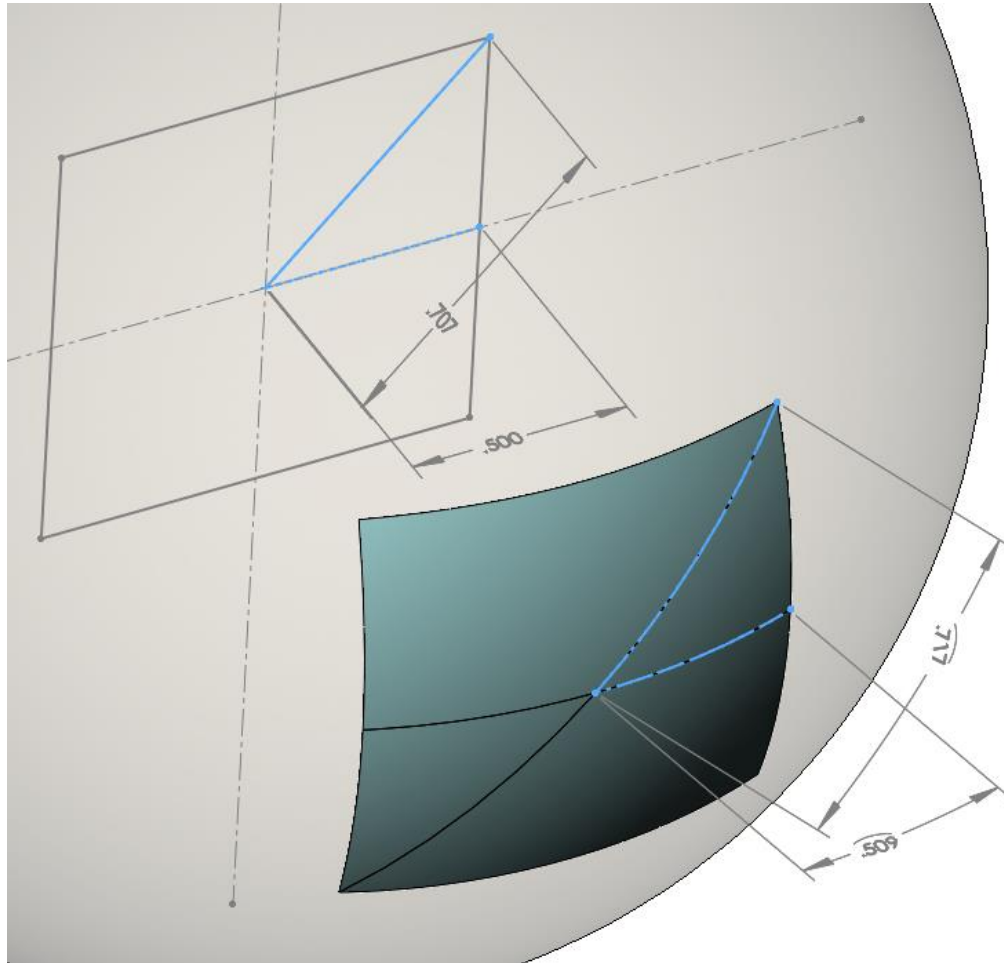

Centered

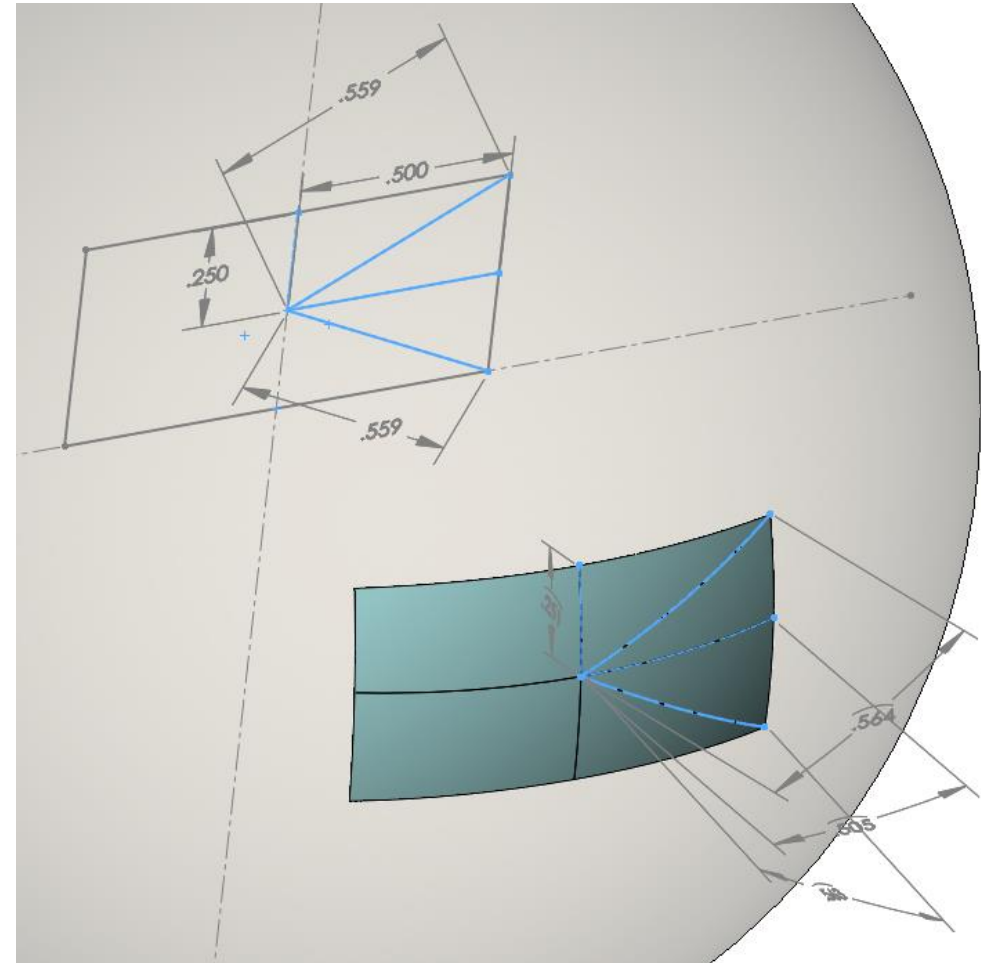

Offset Up

Real World Wrap Functionality

3DS.COM/SOLIDWORKS © Dassault Systèmes | Confidential Information | 2/8/2018 | ref.: 3DS_Document_2014

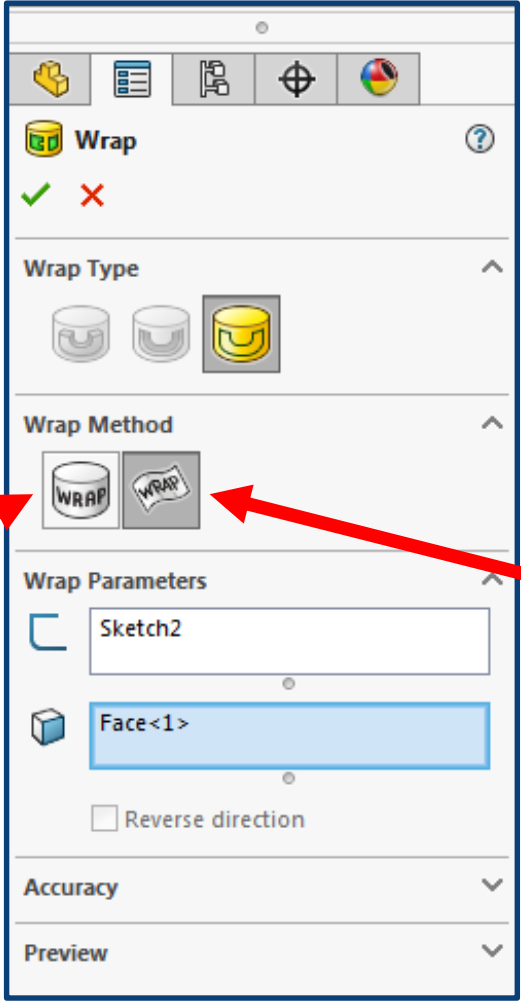

Analytical

Spline

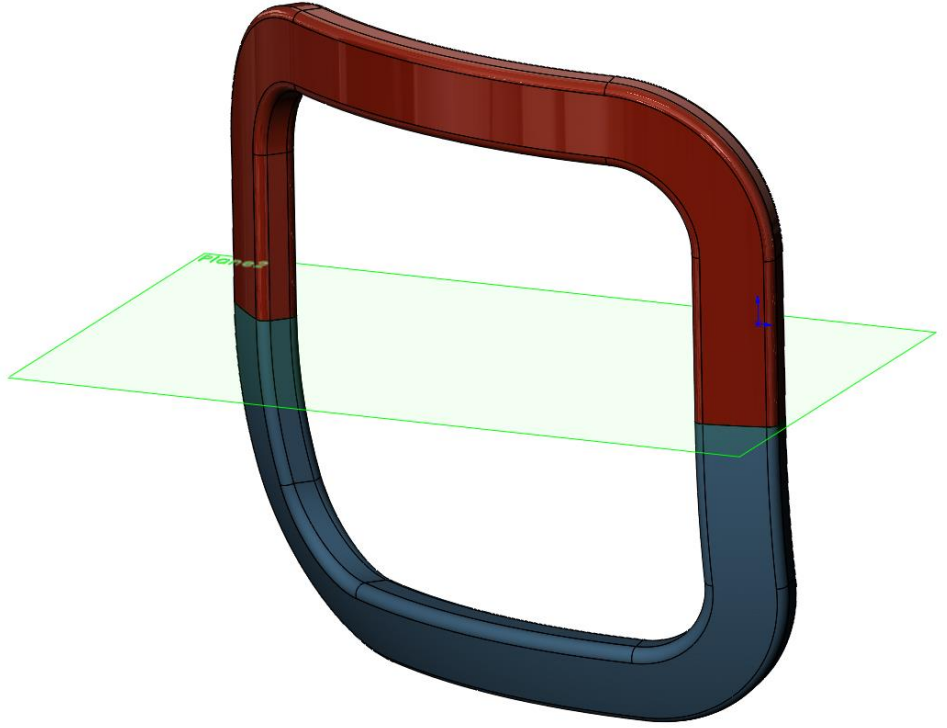
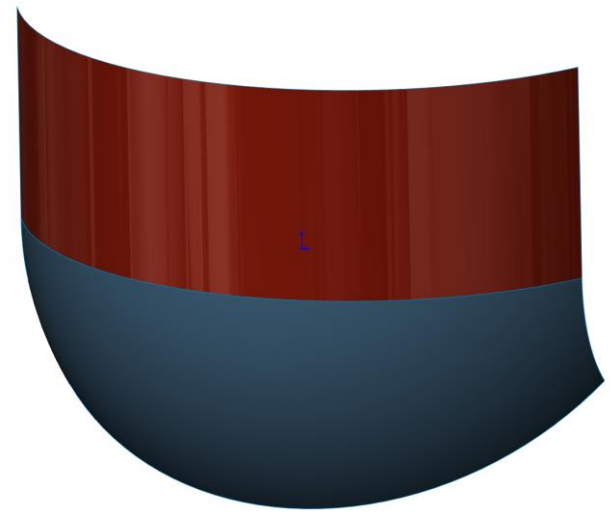

Sketch Planes

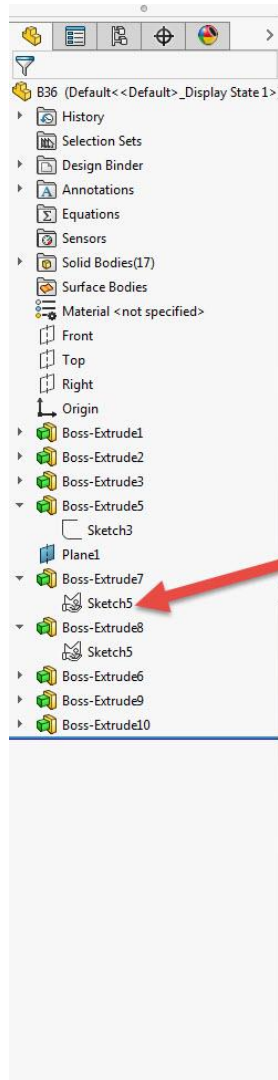

sketch plane should be a plane rather than a face to facilitate edges effecting the rectangular regions

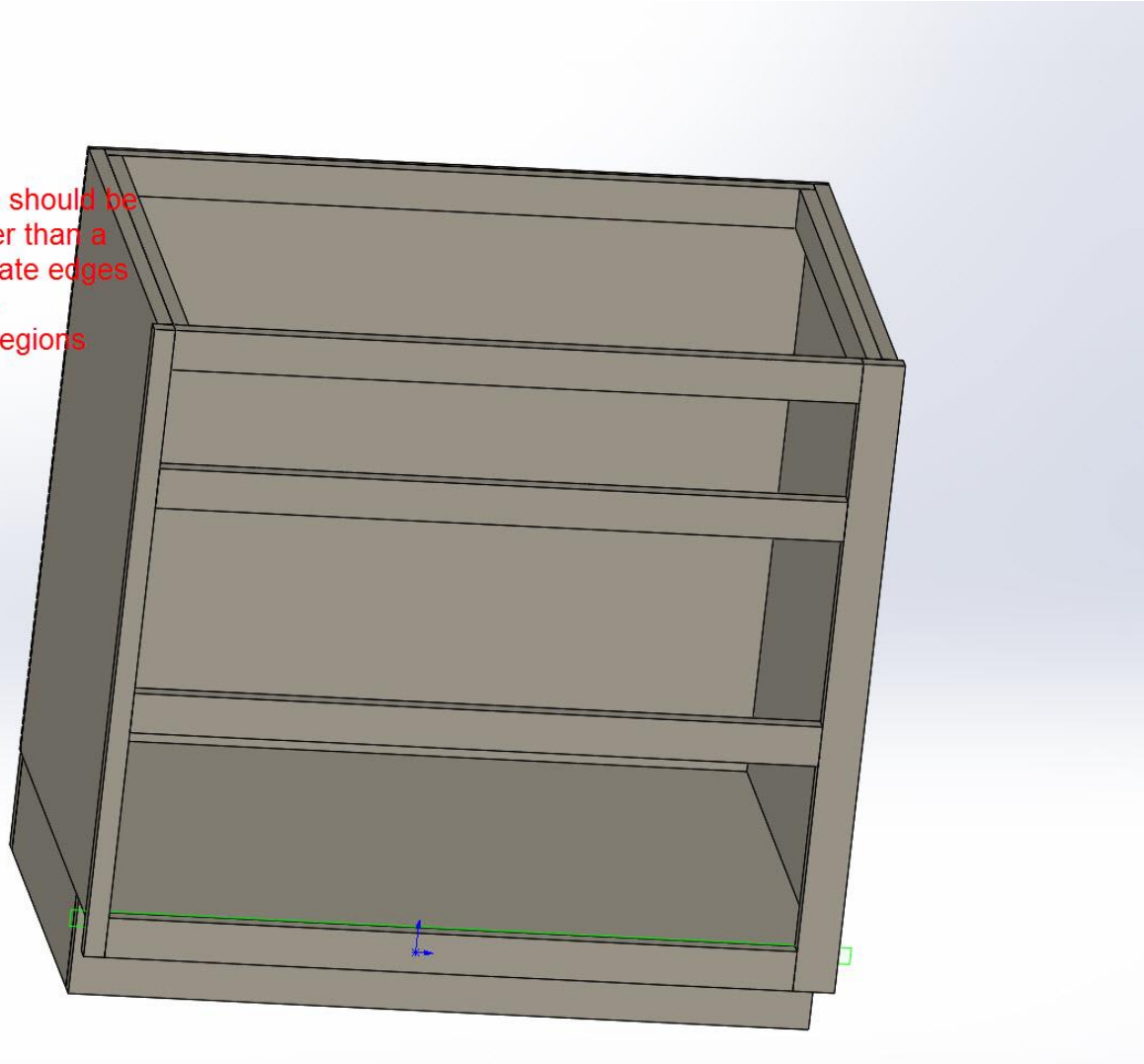

Resolved, Partially Suppressed, and Suppressed Folders

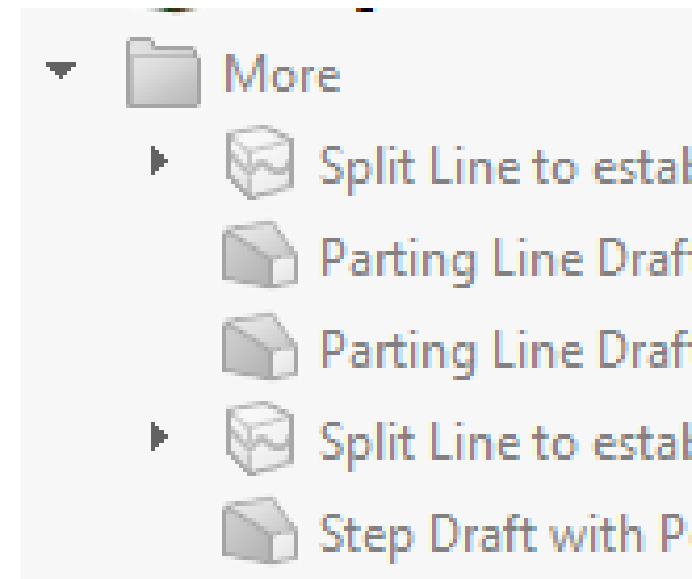
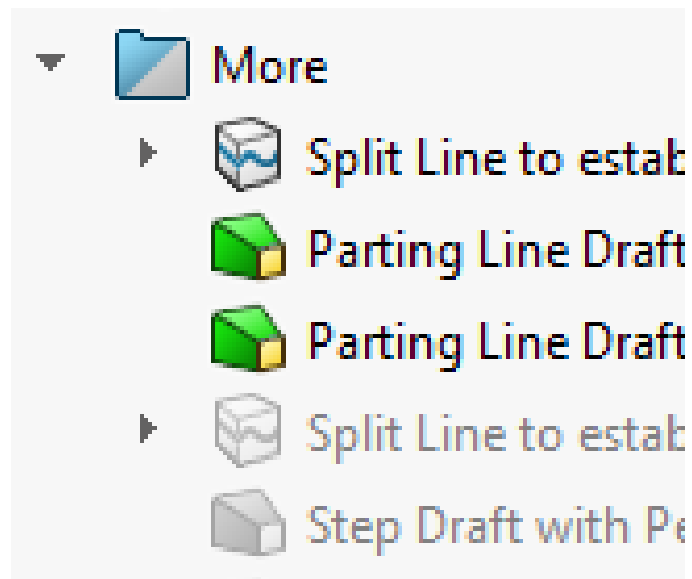
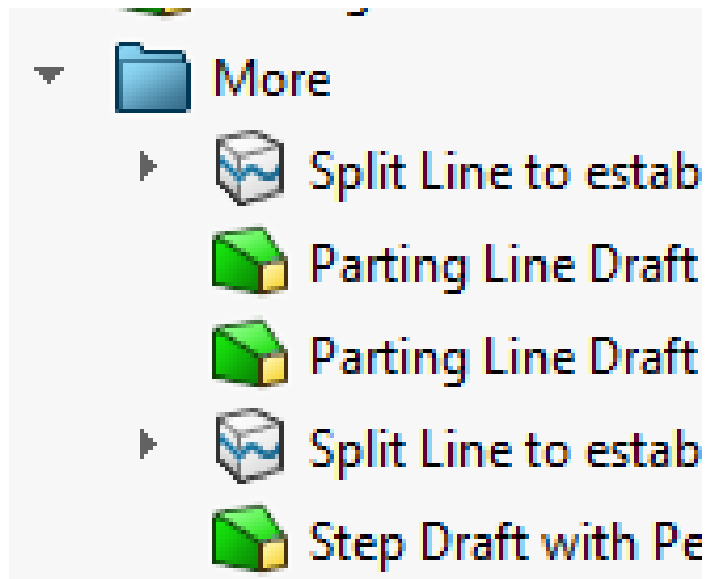

Surfaces – Three Highlights 3/3

Refine

Add

Construct

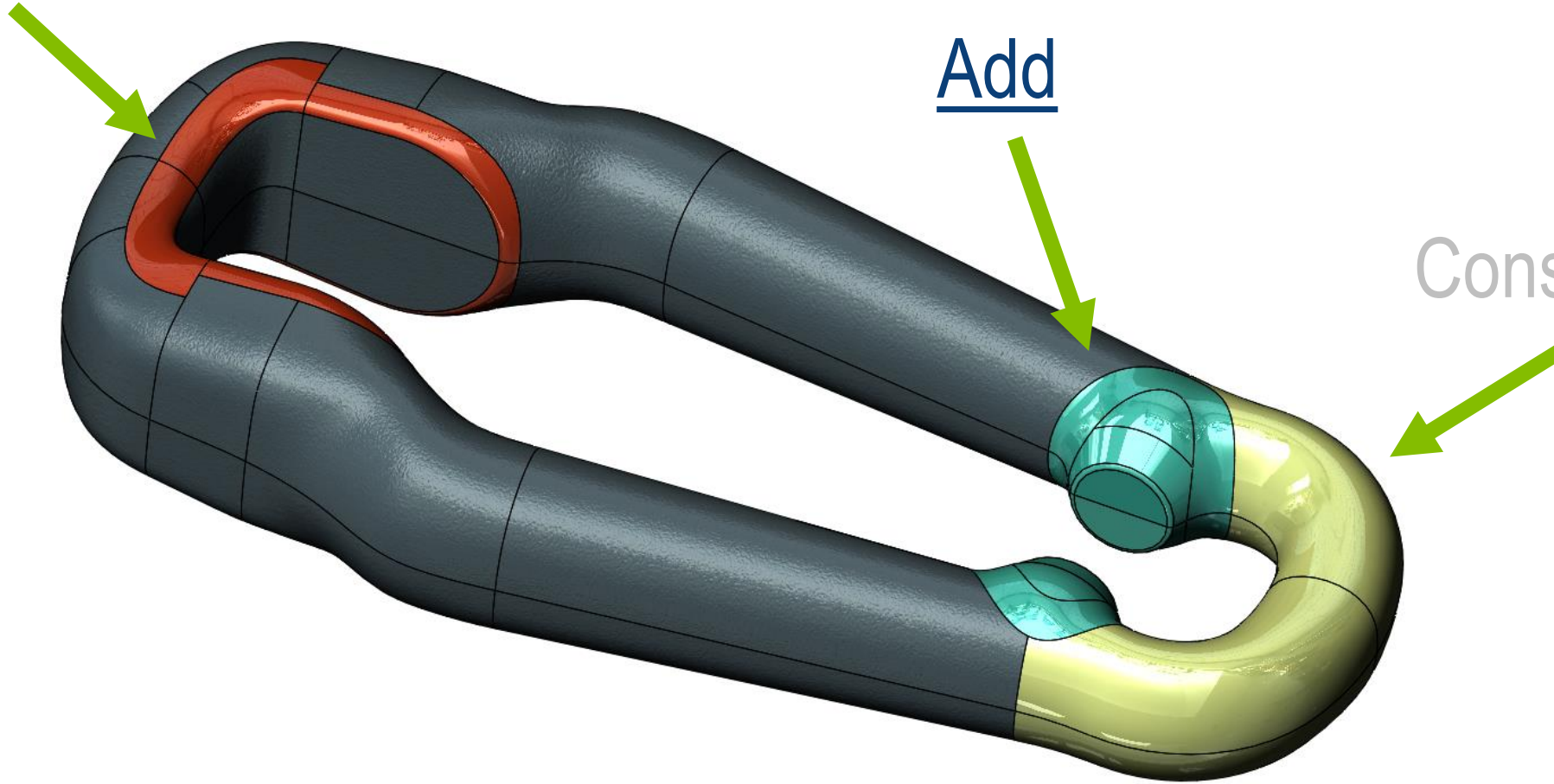

Surface – Flatten

Warning: “Against the goals and objective of this year’s conference”

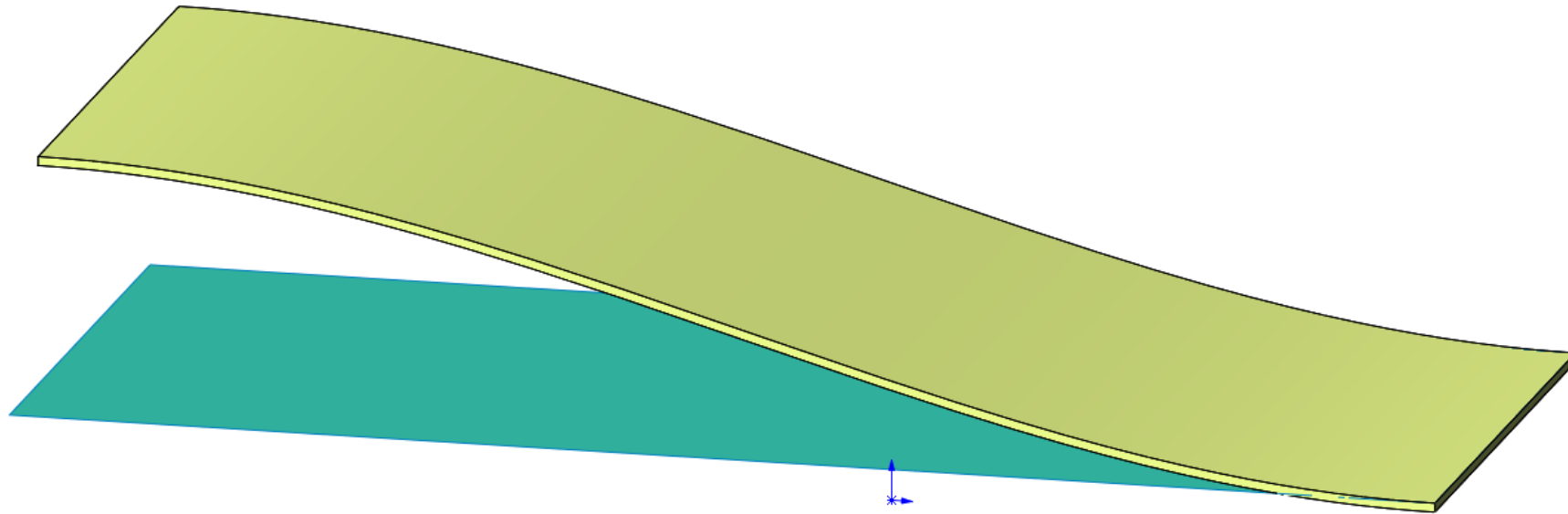

Tubing with Composite Curves

Always practice beforehand, even if you recently knew the same material backwards and forwards.

If you're not fully prepared for a portion of your presentation, leave it out, no one will ever know.

If you're nervous, do a quick calculation of how much money everyone in the audience would be making if they hadn't took off work and showed up to listen to you... no wait, that will make you more nervous. Instead take a deep breath, exhale slowly, and just when you think you have exhaled completely, push a little and exhale some more (it really does work).

The symptoms of being nervous and being excited are exactly the same

There's no backing out now!

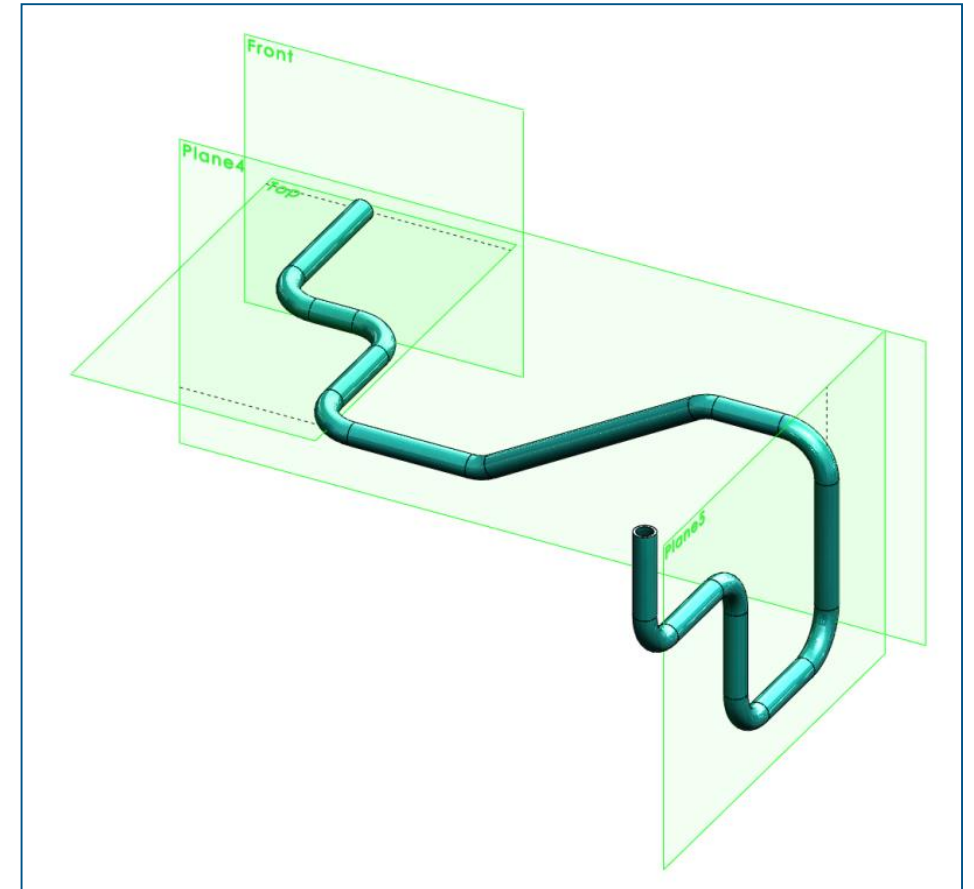

We'll see you down the road!

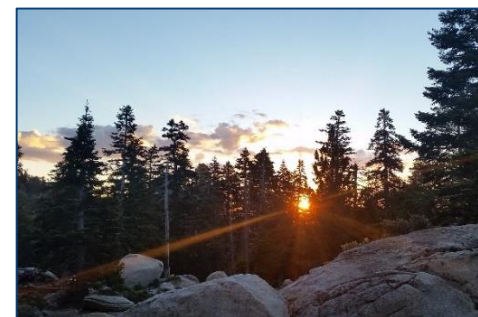

SOLIDWORKS Tips and Tricks 2018

The Last Waltz

Phil Sluder
Mechanical Engineer
TriAxial Design and Analysis, Inc.

sluder@triaxialdesign.com
(619) 787-8725

THINK SOLIDWORKS

CREATE

EXPERIENCE

SPEED

GAME CHANGING

SMART DESIGN

NEXT-GEN

COMMUNITY-DRIVEN

EVOLVE

EXPERT
Mechanical
Design

 SOLIDWORKS